

27th ST. PROFILE

Between
"H" ST and "I" ST.

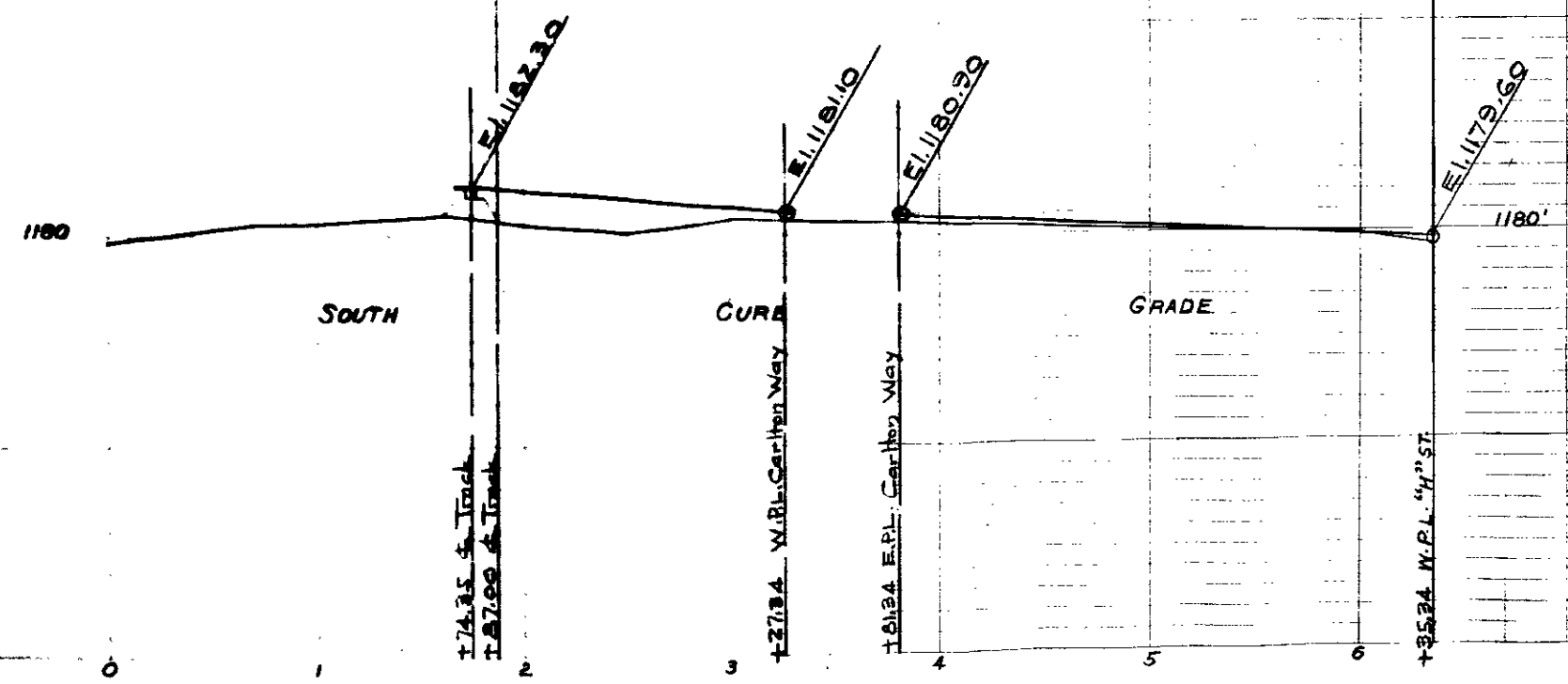
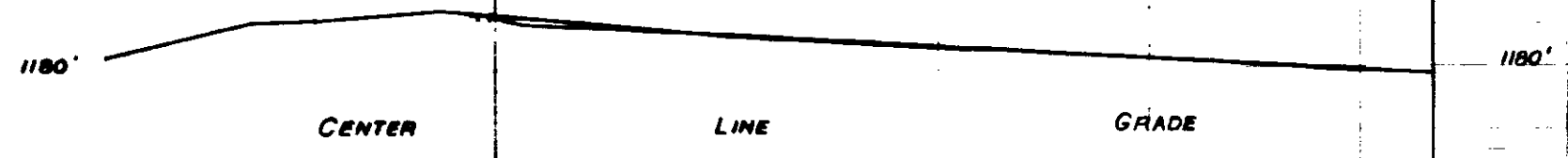
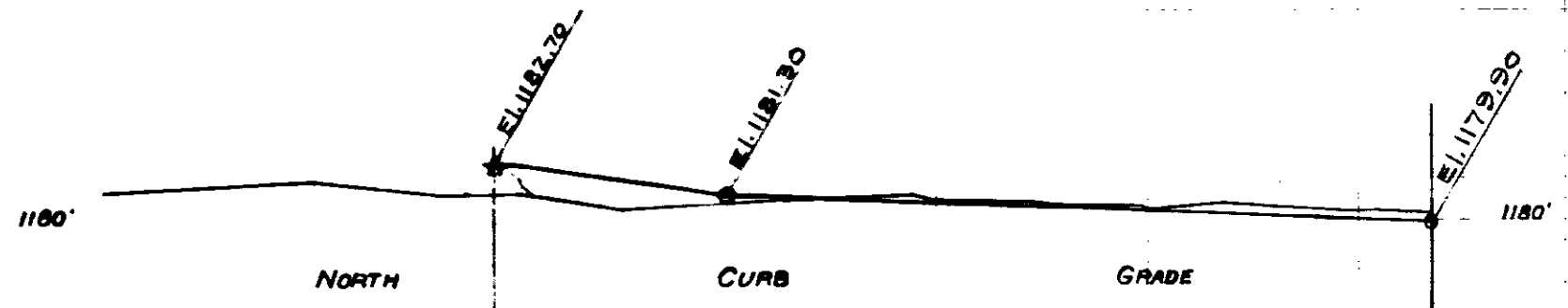

559 WHOLE - 51.4.21 (4.21.21)

655

655

27th ST. PROFILE
Between
 "H" ST and "I" ST.

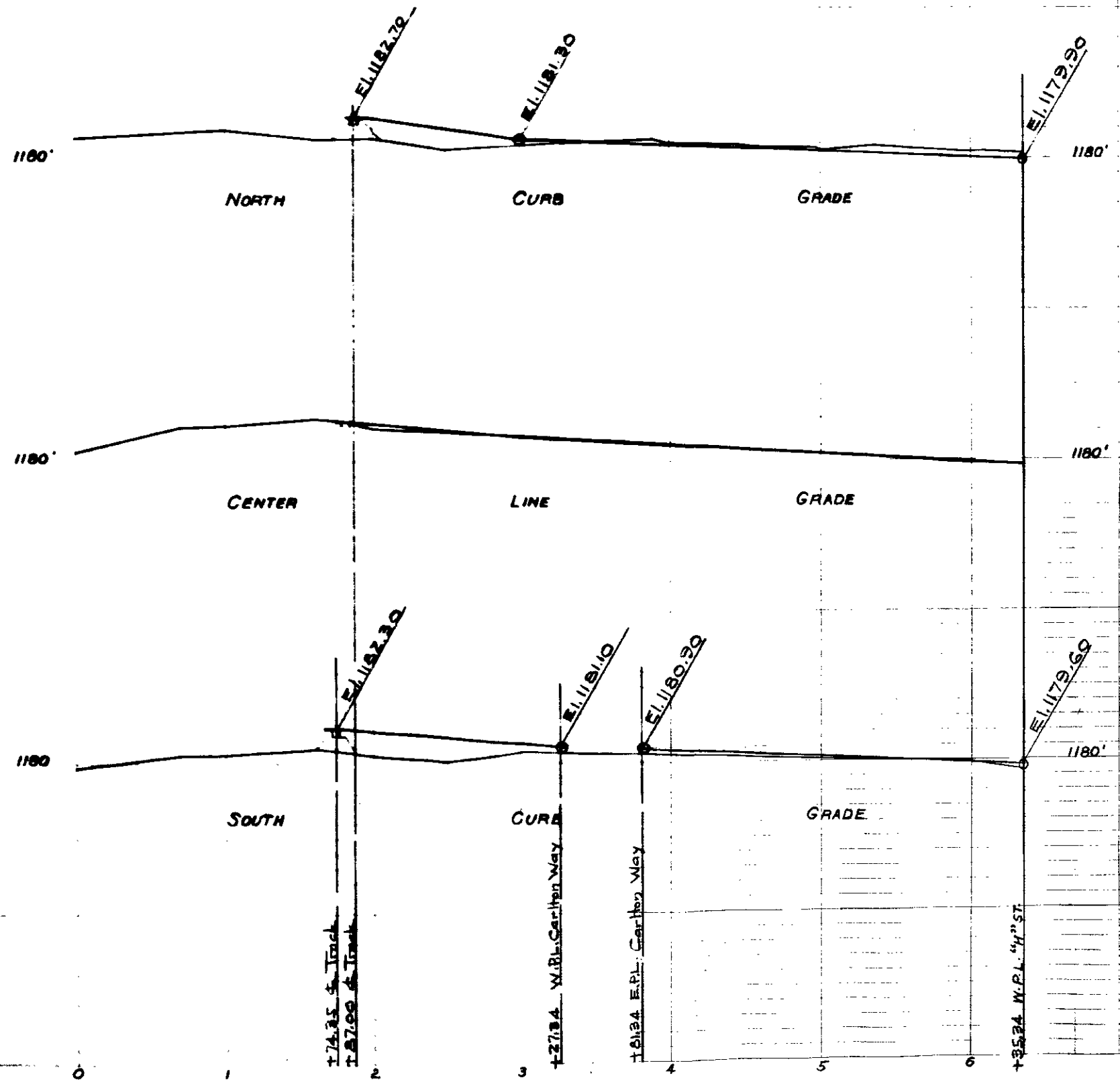

559 WHOLE - 51.4.21 (44.21 1.71)
 174.35 5' Inch
 187.00 4' Inch
 127.84 W.B. Carhon Way
 161.84 E.P. Carhon Way
 135.24 W.P. "H" ST

655
 655
 655